

DENTAL SPACE

For Lease
North Austin, Texas



2121 Parmer Lane

Availability: Thirty Days

Location: Near the intersection of Parmer Lane and Metric Blvd. in North Austin

Size: up to 3,302 Square feet

Lease Rate: First year rate \$18.50 per sq. ft. plus NNN of 4.35 for year 2010

ROBERT R. HEMPHILL, CCIM

COMMERCIAL REAL ESTATE

512-474-2224

roberthemphill@austin.rr.com

<http://www.weleaseaustin.com/listings.htm>

All information regarding this property is from sources deemed reliable, however, Broker has not made an independent investigation of these sources and no warranty or representation is made by the Broker as to the accuracy thereof and same is submitted subject to errors, omissions, change of price, rental or other conditions, prior sale, lease or withdrawal from market without notice. Broker further has not made and shall not make any warranty or representation as to the condition of the property nor the presence of any hazardous substances or any environmental or other conditions that may affect the value or suitability of the property.

1300 West Lynn, Suite 110, Austin, Texas 78703, (512) 474-2224 fax: (512) 474-4224

DENTAL SPACE

2121 Parmer Lane , suite 111

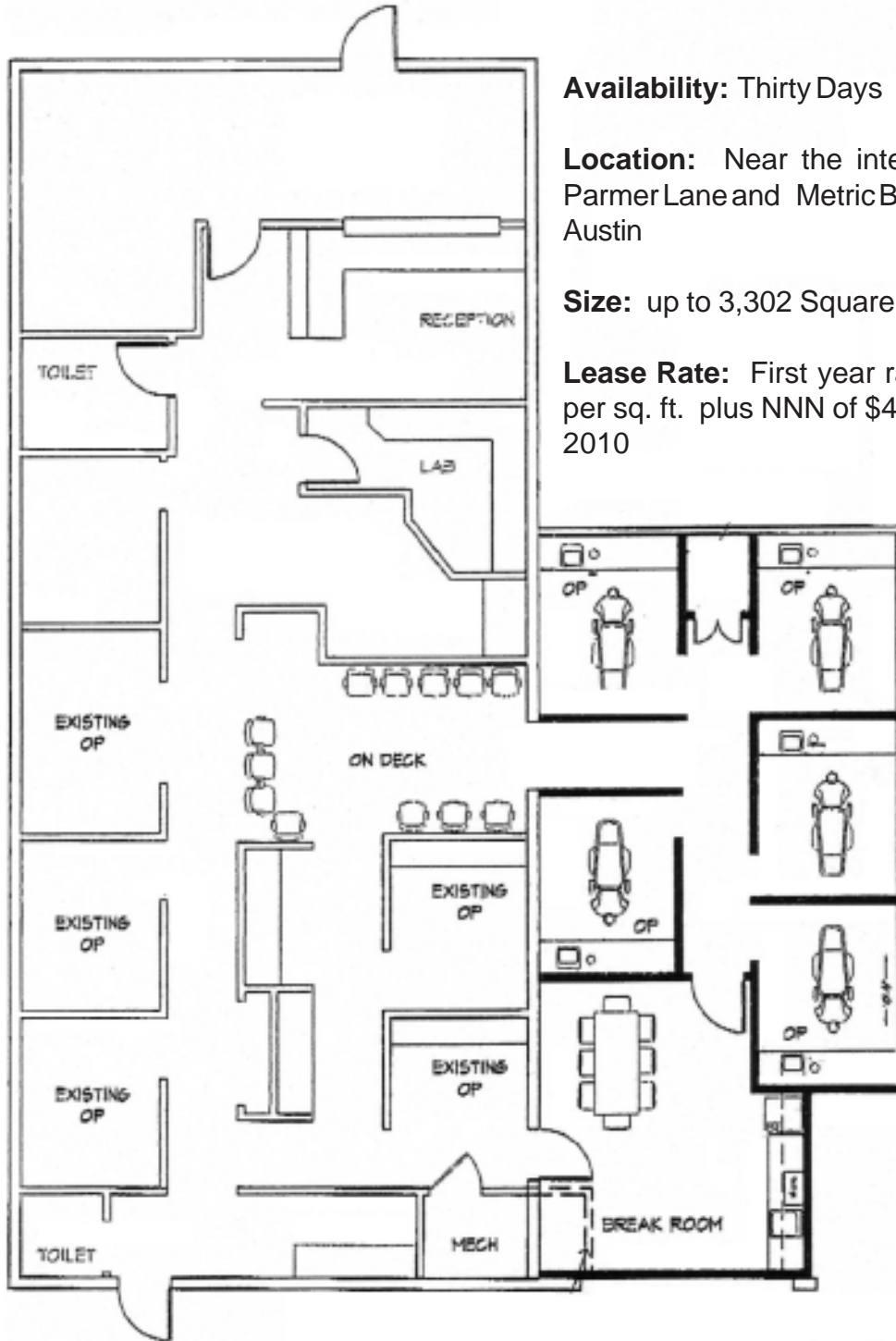

Availability: Thirty Days

Location: Near the intersection of Parmer Lane and Metric Blvd. in North Austin

Size: up to 3,302 Square feet

Lease Rate: First year rate \$18.50 per sq. ft. plus NNN of \$4.35 for year 2010

All information regarding this property is from sources deemed reliable, however, Broker has not made an independent investigation of these sources and no warranty or representation is made by the Broker as to the accuracy thereof and same is submitted subject to errors, omissions, change of price, rental or other conditions, prior sale, lease or withdrawal from market without notice. Broker further has not made and shall not make any warranty or representation as to the condition of the property nor the presence of any hazardous substances or any environmental or other conditions that may affect the value or suitability of the property.

1300 West Lynn, Suite 110, Austin, Texas 78703, (512) 474-2224 fax: (512) 474-4224